

NOTICE

THIS DRAWING EMBODIES A CONFIDENTIAL PROPRIETARY DESIGN ORIGINATED BY G.W. LISK COMPANY INC. AND ALL DESIGN, MANUFACTURING, REPRODUCTION, USE AND SALE RIGHTS REGARDING THE SAME ARE EXPRESSLY RESERVED. IT IS SUBMITTED UNDER A CONFIDENTIAL RELATIONSHIP FOR A SPECIFIC PURPOSE, AND THE RECIPIENT AGREES BY ACCEPTING THIS DRAWING NOT TO SUPPLY OR DISCLOSE ANY INFORMATION REGARDING IT TO ANY UN-AUTHORISED PERSON, OR TO INCORPORATE IN OTHER PROJECTS ANY SPECIAL FEATURES PECULIAR TO THIS DESIGN. ALL PATENT RIGHTS HERETO ARE EXPRESSLY RESERVED BY G.W. LISK COMPANY, INC., CLIFTON SPRINGS, NEW YORK.

REVISIONS

REV	DESCRIPTION	DATE	APPR.
A	DIM. Ø0.505-0.495 WAS 0.475-0.465 AND 0.172-0.162 WAS 0.135-0.125	18-APR-02	R.D.
B	DIM. 1.243-1.237 WAS 1.237-1.227	29-MAY-03	R.D.

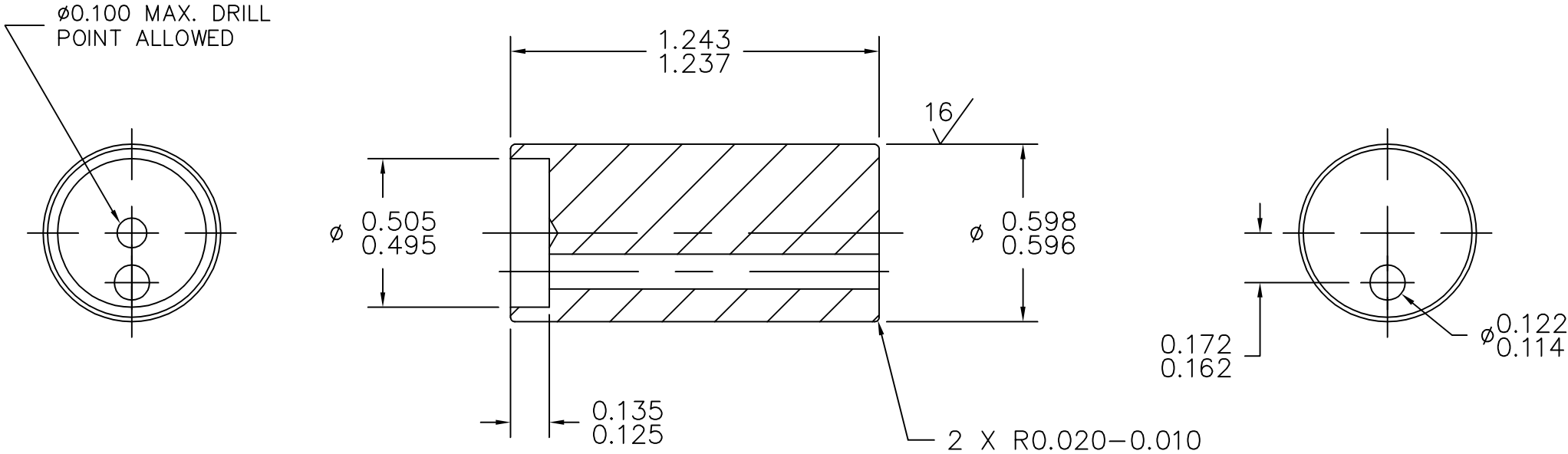

- NOTES:
1. MATERIAL: AISI / SAE 1215 COLD DRAWN CARBON STEEL.
(ACCEPTABLE ALTERNATIVES ARE EN1A, 220M07, 230M07).
 2. MACHINE AND GRIND TO DIMENSIONS SHOWN.

UNLESS OTHERWISE SPECIFIED		ITEM	PART NUMBER	DESCRIPTION	QTY
93 Ra FINISH ALL OVER	INCH	3rd ANGLE PROJ.	DRAWN D.K. 06-MAR-02	LISK IRELAND LTD. ENNIS ROAD GORT CO GALWAY IRELAND	
SMOOTH FINISH FOR APPEARANCE ONLY			CHECK R.D. 08-MAR-02		
ALL DIAMETERS CONCENTRIC WITHIN .005 TOTAL INDICATOR READING	MATERIAL SEE NOTE #1		ENGINEER	PLUNGER	
BREAK ALL SHARP EDGES .010 MAXIMUM	HEAT TREAT - - -		D12-1017		
RADIUS OR CHAMFER ACCEPTABLE	FINISH - - -		D12-2151	SIZE A3	DWG NO H-21496
				DO NOT SCALE	WEIGHT
					SHEET 1 OF 1